

ISOMETRIC VIEW

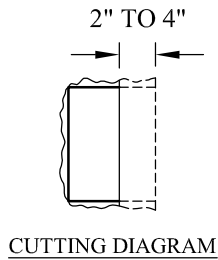

CUTTING DIAGRAM

**NOTES:**

1. ALTERNATE COURSES A AND B UNTIL FULL HEIGHT OF WALL HAS BEEN REACHED
2. CUT 2 TO 4 INCHES FROM CENTER END-UNIT TO MAINTAIN PATTERN
3. AFFIX ALL UNITS WITH CONSTRUCTION-GRADE ADHESIVE

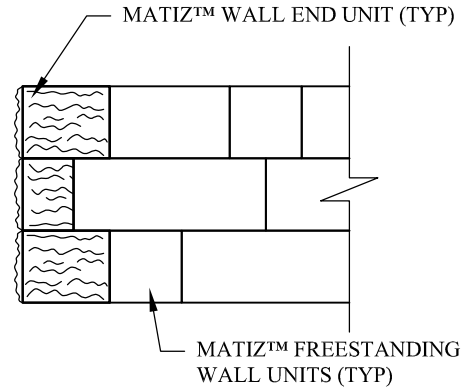

ELEVATION VIEW

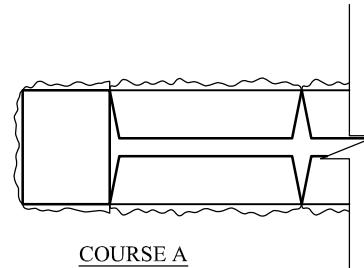

COURSE A

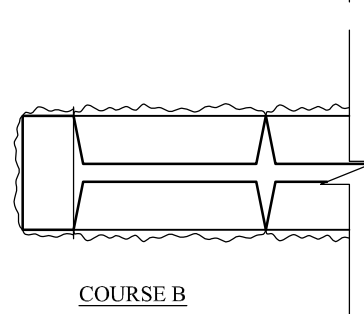

COURSE B

PLAN VIEW



Anchor Wall Systems, Inc.  
5959 Baker Road, Suite 390  
Minnetonka, MN 55345

© 2013 Anchor Wall Systems, Inc.  
® and ™ Anchor Wall Systems, Inc.

Drawn By: SB  
Date: 12/2/2013  
Scale: 1/2" = 1'-0"

Drawing Title:  
**Matiz™ 6" Multipiece Freestanding Wall System  
End of Wall Without Column**

Typical Details For  
Segmental Freestanding Walls